

LAYER STRUCTURE

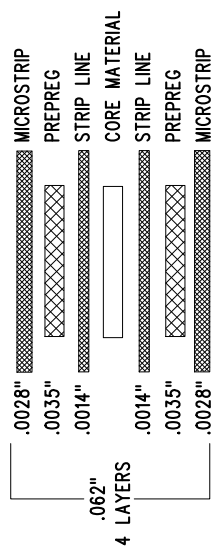

NOTES: UNLESS OTHERWISE SPECIFIED

- 1. FAB PER IPC-A-600.
- 2. MATERIAL: -EPOXY FIBERGLASS, NEMA GRADE FR-4
-FINISHED THICKNESS TO BE 0.062" +/- .005"
-TOTAL OF 4 LAYERS WITH 2 OZ. CU ON THE OUTER LAYERS AND 1 OZ. CU ON THE INNER LAYERS.
-FLAMMABILITY RATING: 94 V-0 MINIMUM.
- 3. SIZE: CUT TO DIMENSIONS AND TOLERANCES SHOWN.
0.00" ARE PRIMARY DATUMS.
- 4. DRILLING: -DRILL HOLES PER SCHEDULE. PLATE THROUGH HOLES WITH COPPER; 0.001" THICK MIN.
-ALL HOLE SIZES ARE SPECIFIED AFTER PLATING.
-HOLE LOCATION TOLERANCES ARE +/-0.003" IN RELATION TO CENTER
-FOR VIAS SIZE > 0.01", VIAS HOLES NEED TO BE PLUGGED AND COVERED WITH SOLDERMASK.
-GOLD IMMERSION BOTH SIDES.
- 5. FINISH: -SMOBC USING LPI BOTH SIDES, COLOR GREEN.
-LEAD FREE SOLDER CAN BE USED FOR PROTOTYPE)
-FOR SILKSCREEN: BOTH SIDES USE WHITE NON-CONDUCTIVE INK.
- 6. DO NOT ALTER ARTWORK e.g. TO ADD LOGO OR DATE CODE.
PAD SIZE CAN BE MODIFIED TO MEET END FINISH.
- 7. PCBs ARE TO BE RoHS COMPLIANT.
- 8. SCORING FOR PANELIZED PCB:

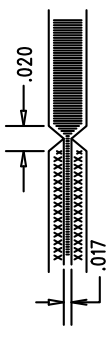

1630 MCCARTHY BLVD
MILPITAS, CA 95035
PH: (408)432-1800
WWW.LINEAR.COM
LTC CONFIDENTIAL -
FOR CUSTOMER USE ONLY

TITLE: FABRICATION DRAWING
20V, 500mA, ULTRA LOW NOISE,
ULTRAHIGH PSRR RF LDO REGULATOR

SIZE IC NO. LT3045EDD
N/A DC2491A

REV 3

FILENAME: DC2491A-3.PCB SHT 1 OF 1

UNLESS OTHERWISE SPECIFIED
DIMENSIONS ARE IN INCHES
TOLERANCES:
0.XX" = ±0.01"
0.XXX" = ±0.005"
INTERPRET DIM AND TOL
PER ASME Y14.5M-1994
THIRD ANGLE PROJECTION

- ADDITIONAL REQUIREMENT FOR PROTOTYPE FAB ONLY:
- 1. OUTGOING INSPECTION REPORT (BASED ON ACTUAL MEASUREMENTS AND CROSS SECTION).
- ADDITIONAL REQUIREMENTS FOR PRODUCTION FAB ONLY:
- 1. PROVIDE COMPLIANCE CERTIFICATES FOR RoHS, REACH AND CONFLICT-FREE MINERALS.
 - 2. SOLDERABILITY BOARD WITH TEST RESULTS.
 - 3. OUTGOING INSPECTION REPORT (BASED ON ACTUAL MEASUREMENTS AND CROSS SECTION).
 - 4. VACUUM PACKED WITH DESICCANT.
 - 5. FULL PANEL WITH NO REJECT.

SIZE	QTY	SYM	PLATED	TOL
0.01	97	+	YES	+/-0.003
0.095	6	×	YES	+/-0.003
0.187	4	□	NO	+/-0.003
0.07	2	◇	NO	+/-0.003
0.035	6	⊗	YES	+/-0.003
0.006	1	⊗	YES	+/-0.003
0.055	10	⊕	YES	+/-0.003