

LTC CONFIDENTIAL - For Customer Use Only

DWG NO. DC2155A		SH 1	REV 4	2	1
REVISION HISTORY					
ECO	REV	DESCRIPTION		DATE	APPROVED
	4	PROD		09/02/15	<i>[Signature]</i>

LAYER CONSTRUCTION

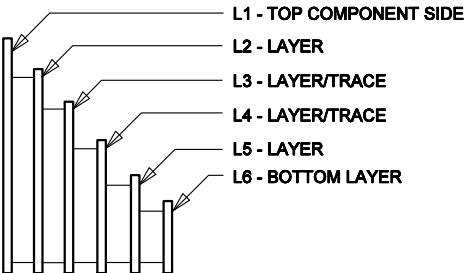

NOTES: UNLESS OTHERWISE SPECIFIED,

- ARTWORK P/N DC2155A REV 4.
- FAB PER IPC-A-600
- PCB SHALL MEET RoHS COMPLIANCE.
- MATERIAL:
  - A. LAMINATE: EPOXY FIBERGLASS, NEMA GRADE FR-4  
FLAMMABILITY RATING: 94 V-2 MINIMUM.
  - B. THICKNESS: 1.6 +/- 0.1 mm
  - C. CLAD: 2 OZ. (50um) EXTERNAL LAYERS.  
1 OZ. (25um) COPPER ON TWO INTERNAL LAYERS.
- FINISH:
  - A. COATING: SOLDERMASK OVER BARE COPPER,  
COLOR, GREEN LPI.
  - B. PLATING: GOLD IMMERSION BOTH SIDES.
  - C. SILKSCREEN: BOTH SIDES WITH WHITE  
NON-CONDUCTIVE INK.
- TOLERANCES:
  - A. WARPAGE: (0,0075mm) MAX. ALONG THE LONGEST  
DIAG. AS PER IPC-TM650 METHOD 2.4.22.
  - B. ETCHING: +0.03mm, -0.3mm OF MASTER PATTERN.
  - C. REGISTRATION: 0.075mm MAX.
  - D. MASK THICKNESS: 0.025mm MIN., 0.075mm MAX.
  - E. HOLE PLATING: 22um +/- 3um.
- SIZE:
  - A. CUT TO DIMENSIONS AND TOLERANCES SHOWN.  
0.00 ARE PRIMARY DATUMS.
- HOLE DIAMETERS ARE POST-PLATED SIZES.
- DEBURR AND BREAK ALL SHARP EDGES.
- DO NOT ALTER ARTWORK e.g. TO ADD LOGO OR  
DATE CODE.

SIZE	QTY	SYM	PLATED	TOL
0.25	990	+	YES	+/-0.08
1	70	×	YES	+/-0.08
1.4	10	□	YES	+/-0.08
1.8	2	◇	NO	+/- .13
2.4	26	⊗	YES	+/-0.13
4.75	4	⊗	NO	+/-0.13
4.96	6	⊕ <sup>A</sup>	YES	+/-0.13

COMPONENT SIDE SHOWN

UNLESS OTHERWISE SPECIFIED  
DIMENSIONS ARE IN MILLIMETERS  
TOLERANCES ON ANGLE ± 1°

.XX ± 0.25  
XXX ± 0.127

THIRD ANGLE PROJECTION

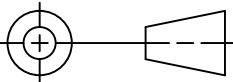

DO NOT SCALE DRAWING

CONTRACT NO

APPROVALS

DATE

DRAWN

06/11/15

CHECKED

APPROVED

ENGINEER

09/02/15



1630 McCarthy Blvd.  
Milpitas, CA 95035  
Phone: (408)432-1900  
Fax: (408)434-0507

TITLE

FAB, LTC3886EUJ, HIGH VOLTAGE DUAL STEP-DOWN  
DC/DC CONVERTER WITH POWER SYSTEM  
MANAGEMENT

SIZE  
B

CAGE CODE

DWG NO

DC2155A

REV  
4

SCALE 1/1

FILENAME: 2155A-4.PCB

SHEET 1 OF 1